

地番	開発面積			
測点名	X座標	Y座標	Y n+1-Y n-1	X n(Y n+1-Y n-1)
1	-206634.255	-65371.833	-1.790	369875.316450
2	-206632.704	-65372.731	-3.599	743671.101696
3	-206628.817	-65375.432	-3.335	689107.104695
4	-206629.285	-65376.066	-6.775	1399913.405875
Au53	-206622.085	-65382.207	-6.242	1289735.054570
5	-206621.966	-65382.308	-4.779	987446.375514
6	-206616.934	-65386.986	-8.750	1807898.172500
7	-206614.146	-65391.058	-5.694	1176460.947324
Au221	-206613.258	-65392.680	-5.020	1037198.555160
8	-206611.399	-65396.078	-9.673	1998552.062527
9	-206608.867	-65402.353	-10.491	2167533.623697
Au65	-206606.947	-65406.569	-8.347	1724548.186609
10	-206605.066	-65410.700	11.473	-2370379.922218
11	-206584.506	-65395.096	27.207	-5620544.654742
12	-206565.946	-65383.493	12.381	-2557492.977426
13	-206566.840	-65382.715	4.772	-985736.960480
14	-206572.133	-65378.721	5.018	-1036578.963394
15	-206573.490	-65377.697	1.869	-386085.852810
16	-206575.088	-65376.852	3.098	-639969.622624
17	-206580.325	-65374.599	3.048	-629656.830600
18	-206582.418	-65373.804	3.333	-688539.199194
19	-206583.896	-65371.266	5.916	-1222150.328736
20	-206588.874	-65367.888	5.613	-1159583.349762
Au200	-206592.616	-65365.653	6.266	-1294509.331856
Au201	-206591.299	-65361.622	3.663	-756743.928237
*1014	-206590.173	-65361.990	-4.316	891643.186668
*1012	-206574.338	-65365.938	-4.791	989697.653358
*1013	-206569.270	-65366.781	0.121	-24994.881670
Au244	-206568.970	-65365.817	1.927	-398058.405190
*1010	-206568.669	-65364.854	4.396	-908075.868924
Au50	-206564.866	-65361.421	5.878	-1214188.282348
1015	-206562.158	-65358.976	9.589	-1980724.533062
1016	-206555.547	-65351.832	13.656	-2820722.549832
36	-206559.517	-65345.320	8.064	-1665695.945088
35	-206561.532	-65343.768	5.583	-1153233.033156
34	-206568.501	-65339.737	4.105	-847963.696605
Au203	-206569.099	-65339.663	0.833	-172072.059467
33	-206575.246	-65338.904	5.327	-1100426.335442
Au230	-206582.100	-65334.336	7.342	-1516725.778200
32	-206586.262	-65331.562	8.313	-1717351.596006
31	-206594.531	-65326.023	5.774	-1192876.821994
56	-206594.883	-65325.788	0.296	-61152.085368
Au223	-206594.974	-65325.727	0.947	-195645.440378
*1001	-206596.301	-65324.841	-1.970	406994.712970
Au206	-206598.217	-65327.697	-4.517	933204.146189
*1002	-206599.343	-65329.358	-3.204	661944.294972
Au236	-206600.621	-65330.901	-3.046	629305.491566
*1003	-206601.865	-65332.404	-5.569	1150565.786185
*1004	-206605.667	-65336.470	-7.461	1541484.881487
Au39	-206609.228	-65339.865	-3.589	741520.519292
*1005	-206609.432	-65340.059	-3.597	743174.126904
*1006	-206613.112	-65343.462	-4.295	887403.316040
Au241	-206613.605	-65344.354	-1.784	368598.671320
23	-206614.098	-65345.246	-5.659	1169229.180582
Au51	-206617.869	-65350.013	-11.697	2416809.213693
24	-206623.352	-65356.943	-9.290	1919530.940080
Au60	-206625.219	-65359.303	-13.998	2892339.815562
25	-206634.427	-65370.941	-12.530	2589129.370310
			倍面積	6635.978986
			面積	3317.9894930
			地積	3317.98 m ²

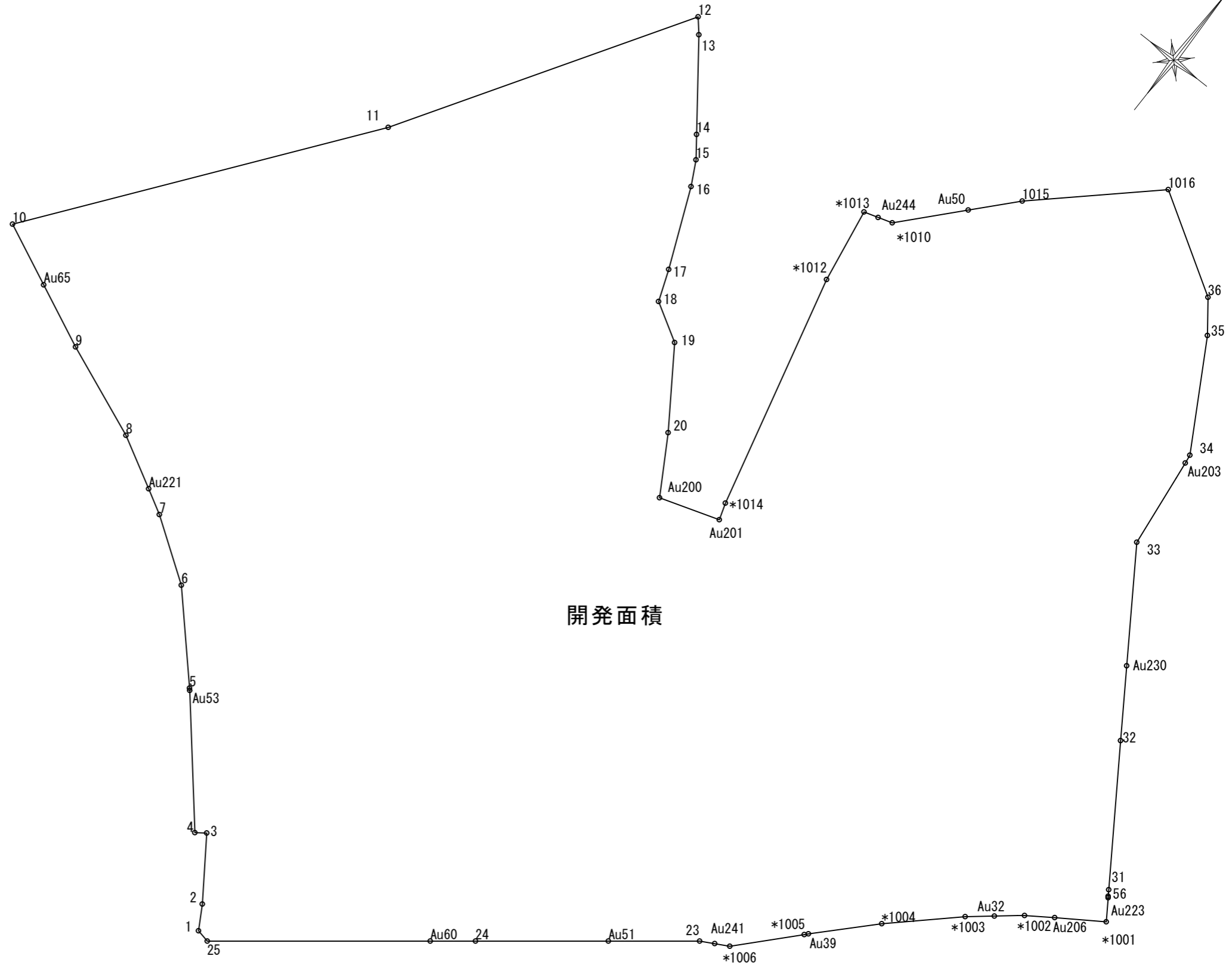

開発面積

開発面積 3317.98 m²

事業名	(仮称) 黒川字中山造成工事			
図面名称	求積図 1 / 4			
図面番号	4-1	縮尺	1:300	
設計者	上坂章人	印		
株式会社クラスイー				

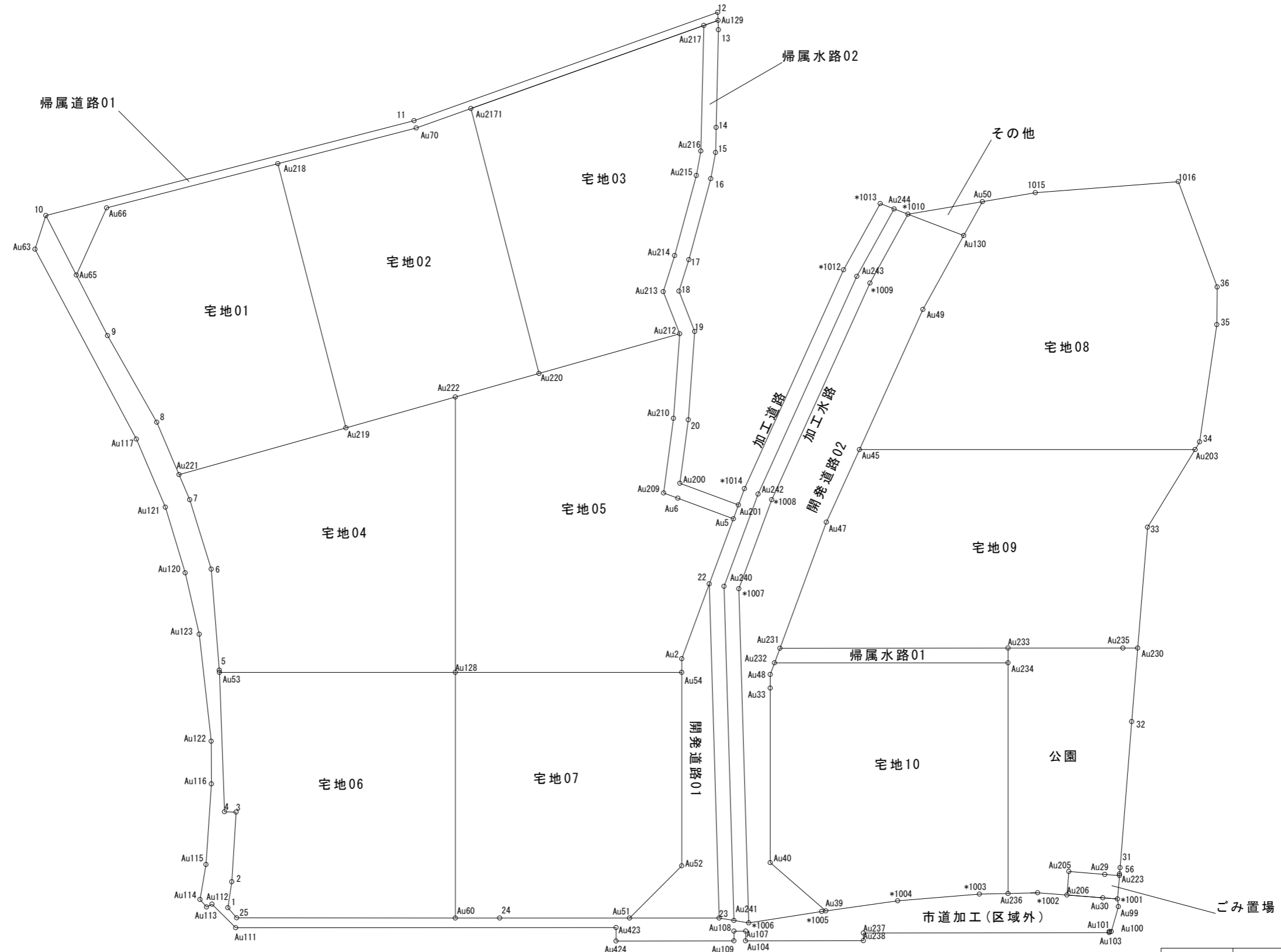
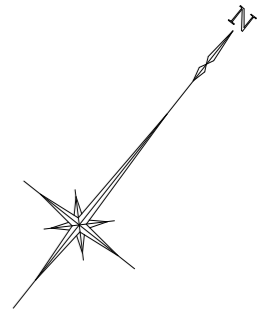

事業名	(仮称) 黒川字中山造成工事		
図面名称	求積図 2 / 4		
図面番号	4-2	縮尺	1:300
設計者	上坂章人	印	
株式会社クラスイー			

地番	加工道路			
測点名	X座標	Y座標	Y n+1-Y n-1	X n(Y n+1-Y n-1)
*1013	-206569.270	-65366.781	0.121	-24994.881670
Au244	-206568.970	-65365.817	1.823	-376575.232310
Au243	-206574.134	-65364.958	4.788	-989076.953592
Au242	-206589.892	-65361.029	6.003	-1240159.121676
Au240	-206596.239	-65358.955	16.675	-3444992.285325
Au241	-206613.605	-65344.354	13.709	-2832465.910945
23	-206614.098	-65345.246	-15.491	3200658.992118
22	-206596.734	-65359.845	-16.065	3318976.531710
Au5	-206592.249	-65361.311	-1.777	367114.426473
Au201	-206591.299	-65361.622	-0.679	140275.492021
*1014	-206590.173	-65361.990	-4.316	891643.186668
*1012	-206574.338	-65365.938	-4.791	989697.653358
倍面積				101.896830
面積				50.9484150
地積				50.94 m ²

地番	加工水路			
測点名	X座標	Y座標	Y n+1-Y n-1	X n(Y n+1-Y n-1)
Au244	-206568.970	-65365.817	0.104	-21483.172880
*1010	-206568.669	-65364.854	1.839	-379879.782291
*1009	-206573.931	-65363.978	4.788	-989075.981628
*1008	-206589.619	-65360.066	5.913	-1221564.417147
*1007	-206595.744	-65358.065	16.604	-3430315.733376
*1006	-206613.112	-65343.462	13.711	-2832872.378632
Au241	-206613.605	-65344.354	-15.493	3201064.582265
Au240	-206596.239	-65358.955	-16.675	3444992.285325
Au242	-206589.892	-65361.029	-6.003	1240159.121676
Au243	-206574.134	-65364.958	-4.788	989076.953592
倍面積				101.476904
面積				50.7384520
地積				50.73 m ²

地番	ごみ置場			
測点名	X座標	Y座標	Y n+1-Y n-1	X n(Y n+1-Y n-1)
Au205	-206596.888	-65328.587	1.138	-235107.258544
Au29	-206595.530	-65326.559	2.860	-590863.215800
Au223	-206594.974	-65325.727	1.718	-354930.165332
*1001	-206596.301	-65324.841	0.054	-11156.200254
Au30	-206596.856	-65325.673	-2.856	590040.620736
Au206	-206598.217	-65327.697	-2.914	602027.204338
倍面積				10.985144
面積				5.4925720
地積				5.49 m ²

地番	その他			
測点名	X座標	Y座標	Y n+1-Y n-1	X n(Y n+1-Y n-1)
*1010	-206568.669	-65364.854	-0.432	89237.665008
Au50	-206564.866	-65361.421	3.865	-798373.207090
Au130	-206567.464	-65360.989	-3.433	709146.103912
倍面積				10.561830
面積				5.2809150
地積				5.28 m ²

地番	市道加工(区域外)			
測点名	X座標	Y座標	Y n+1-Y n-1	X n(Y n+1-Y n-1)
10	-206605.066	-65410.700	3.288	-679317.457008
Au65	-206606.947	-65406.569	8.347	-1724548.186609
9	-206608.867	-65402.353	10.491	-2167533.623697
8	-206611.399	-65396.078	9.673	-1998552.062527
Au221	-206613.258	-65392.680	5.020	-1037198.555160
7	-206614.146	-65391.058	5.694	-1176460.947324
6	-206616.934	-65386.986	8.750	-1807898.172500
5	-206621.966	-65382.308	4.779	-987446.375514
Au53	-206622.085	-65382.207	6.242	-1289735.054570
4	-206629.285	-65376.066	6.775	-1399913.405875
3	-206628.817	-65375.432	3.335	-689107.104695
2	-206632.704	-65372.731	3.599	-743671.101696
1	-206634.255	-65371.833	1.790	-369875.316450
25	-206634.427	-65370.941	12.530	-2589129.370310
Au60	-206625.219	-65359.303	13.998	-2892339.815562
24	-206623.352	-65356.943	9.290	-1919530.940080
Au51	-206617.869	-65350.013	11.697	-2416809.213693
23	-206614.098	-65345.246	6.551	-1353528.955998
*1006	-206613.112	-65343.462	5.187	-1071702.211944
*1005	-206609.432	-65340.059	3.597	-743174.126904
Au39	-206609.228	-65339.865	3.589	-741520.519292
*1004	-206605.667	-65336.470	7.461	-1541484.881487
*1003	-206601.865	-65332.404	6.747	-1393942.783155
Au32	-206599.645	-65329.723	3.046	-629302.518670
*1002	-206599.343	-65329.358	2.026	-418570.268918
Au206	-206598.217	-65327.697	4.517	-933204.146189
*1001	-206596.301	-65324.841	3.228	-666892.859628
Au99	-206596.669	-65324.469	1.038	-214447.342422
Au100	-206598.297	-65323.803	0.558	-115281.849726
Au101	-206598.379	-65323.911	-0.058	11982.705982
Au103	-206598.442	-65323.861	-13.022	2690324.911724
Au237	-206608.817	-65336.933	-12.746	2633435.981482
Au238	-206609.228	-65336.607	-5.942	1227672.032776
Au104	-206614.199	-65342.875	-6.675	1379149.778325
Au107	-206613.677	-65343.282	-1.027	212192.246279
Au108	-206614.176	-65343.902	-0.210	43388.976960
Au109	-206614.694	-65343.492	-5.857	1210142.262758
Au424	-206619.665	-65349.759	-6.836	1412452.029940
Au423	-206618.948	-65350.328	-20.821	4302013.116308
Au111	-206634.993	-65370.580	-22.508	4650940.422444
Au112	-206634.732	-65372.836	-2.421	500262.686172
Au113	-206635.113	-65373.001	-0.841	173780.130033
Au114	-206634.992	-65373.677	-1.822	376488.955424
Au115	-206632.882	-65374.823	-4.261	880462.710202
Au116	-206628.359	-65377.938	-4.918	1016198.269562
Au122	-206626.087	-65379.741	-6.945	1435018.174215
Au123	-206620.903	-65384.883	-8.476	1751318.773828
Au120	-206618.224	-65388.217	-7.163	1480006.338512
Au121	-206615.565	-65392.046	-8.240	1702512.255600
Au117	-206613.153	-65396.457	-17.811	3679986.868083
Au63	-206607.317	-65409.857	-14.243	2942708.016031
倍面積				318.475037
面積				159.2375185
地積				159.23 m ²

公共施設一覧

開発道路 316.21 m²

開発道路01	51.53 m ²
開発道路02	163.01 m ²
加工道路	50.94 m ²
加工水路	50.73 m ²

帰属道路 32.59 m²

帰属道路01	32.59 m ²
--------	----------------------

帰属水路 52.50 m²

帰属水路01	15.66 m ²
帰属水路02	36.84 m ²

公園 130.72 m²

公園	130.72 m ²
----	-----------------------

ごみ置場 5.49 m²

ごみ置場	5.49 m ²
------	---------------------

市道加工(区域外)

市道加工(区域外)	159.23 m ²
-----------	-----------------------

事業名	(仮称)黒川字中山造成工事		
図面名称	求積図4/4		
図面番号	4-4	縮尺	1:300
設計者	上坂章人	印	
株式会社クラスイー			