

面積一覧表

地番名	面積
宅地 1	255.43 m <sup>2</sup>
宅地 2	254.22 m <sup>2</sup>
宅地 3	266.20 m <sup>2</sup>
宅地 4	255.74 m <sup>2</sup>
宅地 5	267.93 m <sup>2</sup>
宅地 6	255.61 m <sup>2</sup>
宅地 7	273.57 m <sup>2</sup>
宅地 8	284.22 m <sup>2</sup>
宅地 9	263.91 m <sup>2</sup>
宅地 10	272.97 m <sup>2</sup>
宅地 11	252.17 m <sup>2</sup>
宅地 12	255.38 m <sup>2</sup>
宅地 13	258.99 m <sup>2</sup>
宅地 14	256.33 m <sup>2</sup>
宅地 15	256.19 m <sup>2</sup>
宅地 16	257.27 m <sup>2</sup>
宅地 17	252.90 m <sup>2</sup>
宅地 18	253.55 m <sup>2</sup>
宅地 19	252.80 m <sup>2</sup>
宅地 20	265.26 m <sup>2</sup>
宅地 21	273.57 m <sup>2</sup>
その他-1	62.25 m <sup>2</sup>
その他-2	187.17 m <sup>2</sup>
公園	252.75 m <sup>2</sup>
集積場	11.35 m <sup>2</sup>
水路	131.97 m <sup>2</sup>
開発道路	1792.96 m <sup>2</sup>
合計	7922.66 m <sup>2</sup>

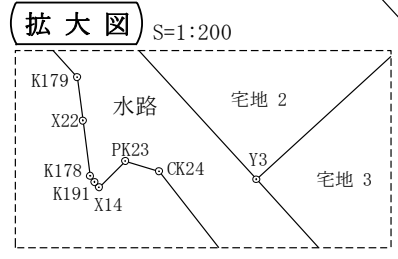
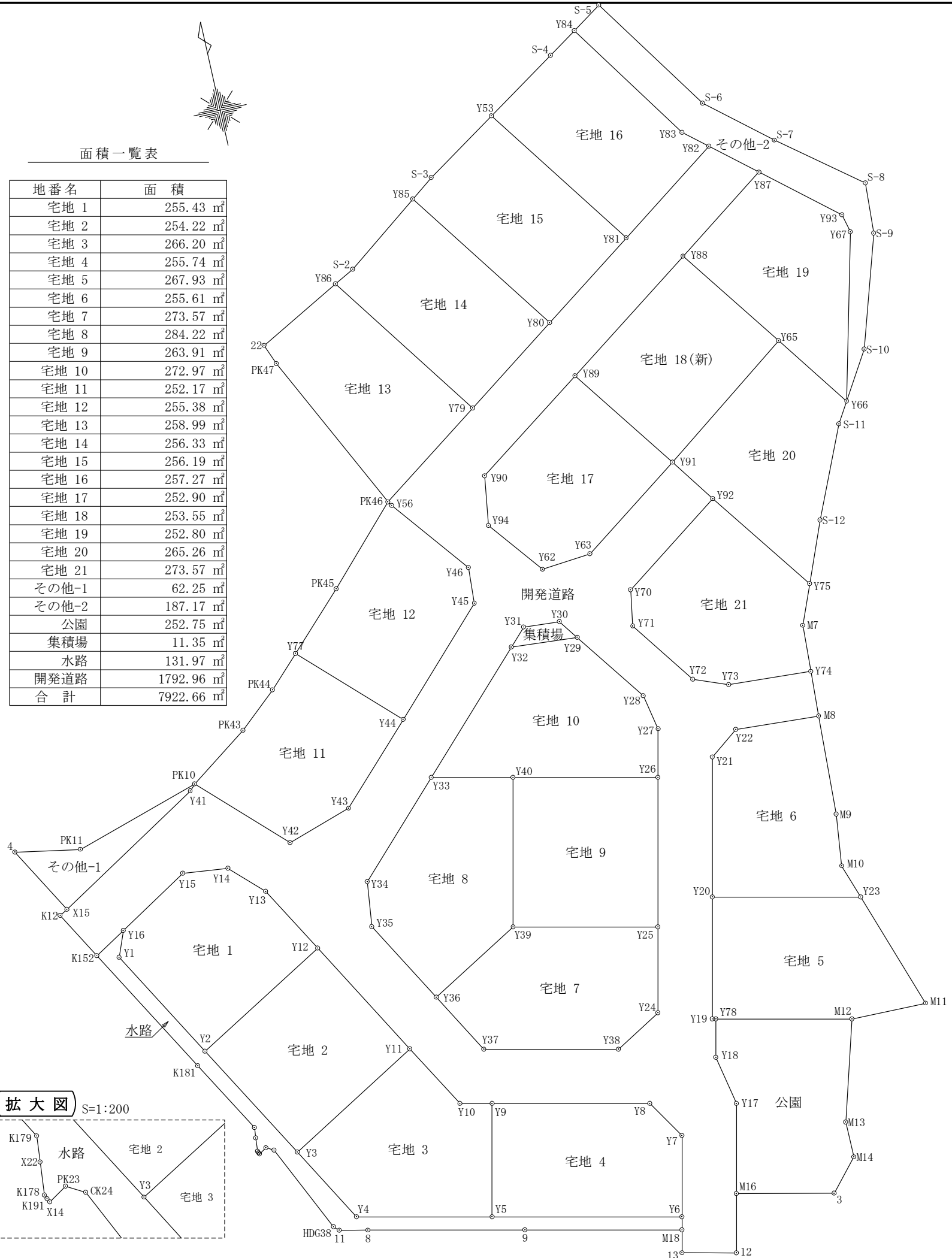

地番	宅地 1		
測点	X n	Y n	距離
Y1	-219757.627	-74410.995	14.051
Y2	-219769.801	-74403.978	16.857
Y12	-219761.384	-74389.373	8.481
Y13	-219754.036	-74393.608	4.907
Y14	-219750.624	-74397.134	5.000
Y15	-219750.072	-74402.103	9.138
Y16	-219754.833	-74409.903	3.000
		地積	255.43 m <sup>2</sup>

地番	宅地 2		
測点	X n	Y n	距離
Y2	-219769.801	-74403.978	15.082
Y3	-219782.868	-74396.447	16.857
Y11	-219774.450	-74381.842	15.081
Y12	-219761.384	-74389.373	16.857
		地積	254.22 m <sup>2</sup>

地番	宅地 3		
測点	X n	Y n	距離
Y3	-219782.868	-74396.447	9.691
Y4	-219791.264	-74391.608	14.950
Y5	-219794.509	-74377.014	12.500
Y9	-219782.307	-74374.301	3.540
Y10	-219781.539	-74377.757	8.182
Y11	-219774.450	-74381.842	16.857
		地積	266.20 m <sup>2</sup>

地番	宅地 4		
測点	X n	Y n	距離
Y5	-219794.509	-74377.014	20.961
Y6	-219799.058	-74356.553	8.964
Y7	-219790.307	-74354.609	5.000
Y8	-219786.088	-74357.292	17.424
Y9	-219782.307	-74374.301	12.500
		地積	255.74 m <sup>2</sup>

地番	宅地 5		
測点	X n	Y n	距離
Y19	-219778.468	-74348.537	0.401
Y78	-219778.555	-74348.146	15.027
M12	-219781.822	-74333.478	8.299
M11	-219781.875	-74325.179	13.726
Y23	-219768.887	-74329.618	16.384
Y20	-219765.326	-74345.610	13.464
		地積	267.93 m <sup>2</sup>

地番	宅地 6		
測点	X n	Y n	距離
Y20	-219765.326	-74345.610	16.384
Y23	-219768.887	-74329.618	4.030
M10	-219765.073	-74330.921	5.737
M9	-219759.373	-74330.269	11.009
M8	-219748.373	-74329.814	9.262
Y22	-219747.836	-74339.060	4.000
Y21	-219750.246	-74342.252	15.449
		地積	255.61 m <sup>2</sup>

地番	宅地 7		
測点	X n	Y n	距離
Y24	-219776.497	-74354.245	9.476
Y25	-219767.248	-74352.185	15.989
Y39	-219763.778	-74367.793	11.501
Y36	-219769.521	-74377.758	7.772
Y37	-219776.255	-74373.877	14.864
Y38	-219779.481	-74359.367	5.928
		地積	273.57 m <sup>2</sup>

地番	宅地 8		
測点	X n	Y n	距離
Y33	-219745.711	-74373.028	13.500
Y34	-219755.412	-74382.416	5.000
Y35	-219760.374	-74383.030	10.558
Y36	-219769.521	-74377.758	11.501
Y39	-219763.778	-74367.793	16.500
Y40	-219747.670	-74364.217	9.026
		地積	284.22 m <sup>2</sup>

地番	宅地 9		
測点	X n	Y n	距離
Y25	-219767.248	-74352.185	16.501
Y26	-219751.142	-74348.598	16.000
Y40	-219747.670	-74364.217	16.500
Y39	-219763.778	-74367.793	15.989
		地積	263.91 m <sup>2</sup>

地番	宅地 10		
測点	X n	Y n	距離
Y26	-219751.142	-74348.598	5.359
Y27	-219745.911	-74347.433	4.000
Y28	-219741.994	-74348.244	9.738
Y29	-219734.109	-74353.959	7.356
Y32	-219733.588	-74361.297	16.870
Y33	-219745.711	-74373.028	9.026
Y40	-219747.670	-74364.217	16.000
		地積	272.97 m <sup>2</sup>

地番	宅地 11		
測点	X n	Y n	距離
PK10	-219740.754	-74398.705	12.364
Y42	-219749.352	-74389.820	7.500
Y43	-219747.057	-74382.680	11.508
Y44	-219738.787	-74374.677	13.938
Y77	-219729.094	-74384.693	4.761
PK44	-219732.472	-74388.048	5.528
PK43	-219736.137	-74392.186	7.988
		地積	252.17 m <sup>2</sup>

地番	宅地 12		
測点	X n	Y n	距離
Y44	-219738.787	-74374.677	15.048
Y45	-219727.973	-74364.213	4.000
Y46	-219723.978	-74364.012	10.869
Y56	-219715.468	-74370.773	0.600
PK46	-219714.979	-74371.120	11.159
PK45	-219723.117	-74378.755	8.425
Y77	-219729.094	-74384.693	13.938
		地積	255.38 m <sup>2</sup>

地番	宅地 13		
測点	X n	Y n	距離
PK46	-219714.979	-74371.120	13.978
Y79	-219706.887	-74359.723	20.405
Y86	-219690.249	-74371.536	10.402
22	-219695.155	-74380.708	2.412
PK47	-219697.398	-74379.820	19.616
		地積	258.99 m <sup>2</sup>

地番	宅地 14		
測点	X n	Y n	距離
Y79	-219706.887	-74359.723	12.671
Y80	-219699.552	-74349.391	20.364
Y85	-219682.948	-74361.180	10.185
S-2	-219689.065	-74369.323	2.510
Y86	-219690.249	-74371.536	20.405
		地積	256.33 m <sup>2</sup>

変更後

図面の名称		図面番号
区画割図		
縮尺 1:500		
設計		

地番 宅地 15			
測点	X n	Y n	距離
Y80	-219699.552	-74349.391	12.623
Y81	-219692.245	-74339.098	20.071
Y53	-219675.879	-74350.717	9.501
S-3	-219681.068	-74358.676	3.131
Y85	-219682.948	-74361.180	20.364
		地積	256.19 m <sup>2</sup>

地番 宅地 16			
測点	X n	Y n	距離
Y81	-219692.245	-74339.098	13.615
Y82	-219684.363	-74327.996	3.341
Y83	-219682.226	-74330.564	16.361
Y84	-219668.677	-74339.735	3.771
S-4	-219670.766	-74342.874	9.362
Y53	-219675.879	-74350.717	20.071
		地積	257.27 m <sup>2</sup>

地番 宅地 17			
測点	X n	Y n	距離
Y89	-219705.876	-74347.934	14.876
Y90	-219714.488	-74360.064	5.500
Y94	-219719.933	-74360.839	7.696
Y62	-219725.962	-74356.055	5.501
Y63	-219725.411	-74350.582	13.610
Y91	-219717.532	-74339.484	14.397
		地積	252.90 m <sup>2</sup>

地番 宅地 18			
測点	X n	Y n	距離
Y88	-219695.569	-74333.417	17.804
Y89	-219705.876	-74347.934	14.397
Y91	-219717.532	-74339.484	17.802
Y65	-219706.976	-74325.149	14.088
		地積	253.55 m <sup>2</sup>

地番 宅地 19			
測点	X n	Y n	距離
Y87	-219688.333	-74323.225	12.499
Y88	-219695.569	-74333.417	14.088
Y65	-219706.976	-74325.149	10.049
Y66	-219715.112	-74319.251	18.694
Y67	-219696.953	-74314.811	2.071
Y93	-219694.938	-74315.288	10.326
		地積	252.80 m <sup>2</sup>

地番 宅地 20			
測点	X n	Y n	距離
Y66	-219715.112	-74319.251	10.049
Y65	-219706.976	-74325.149	17.802
Y91	-219717.532	-74339.484	5.999
Y92	-219722.424	-74336.011	14.208
Y75	-219733.893	-74327.625	7.114
S-12	-219727.290	-74324.977	10.807
S-11	-219717.396	-74320.630	2.668
		地積	265.26 m <sup>2</sup>

地番 宅地 21			
測点	X n	Y n	距離
Y92	-219722.424	-74336.011	13.562
Y70	-219730.275	-74347.069	4.000
Y71	-219734.225	-74347.699	8.860
Y72	-219741.399	-74342.500	4.000
Y73	-219742.844	-74338.770	9.195
Y74	-219743.378	-74329.591	5.160
M7	-219738.223	-74329.360	4.665
Y75	-219733.893	-74327.625	14.208
		地積	273.57 m <sup>2</sup>

地番 その他-1			
測点	X n	Y n	距離
X15	-219751.199	-74415.466	18.877
Y41	-219741.401	-74399.331	0.900
PK10	-219740.754	-74398.705	14.517
PK11	-219745.053	-74412.571	7.229
4	-219743.779	-74419.687	8.537
		地積	62.25 m <sup>2</sup>

地番 その他-2			
測点	X n	Y n	距離
Y66	-219715.112	-74319.251	6.041
S-10	-219709.941	-74316.127	12.850
S-9	-219697.668	-74312.320	5.623
S-8	-219692.053	-74312.016	11.102
S-7	-219685.272	-74320.806	8.896
S-6	-219679.582	-74327.644	15.784
S-5	-219666.511	-74336.492	3.900
Y84	-219668.677	-74339.735	16.361
Y83	-219682.226	-74330.564	3.341
Y82	-219684.363	-74327.996	6.207
Y87	-219688.333	-74323.225	10.326
Y93	-219694.938	-74315.288	2.071
Y67	-219696.953	-74314.811	18.694
		地積	187.17 m <sup>2</sup>

地番 公園			
測点	X n	Y n	距離
M16	-219797.862	-74350.134	10.798
3	-219800.173	-74339.586	4.575
M14	-219796.720	-74336.585	3.950
M13	-219792.770	-74336.633	11.394
M12	-219781.822	-74333.478	15.027
Y78	-219778.555	-74348.146	4.242
Y18	-219782.696	-74349.068	5.573
Y17	-219788.160	-74347.973	9.940
		地積	252.75 m <sup>2</sup>

地番 集積場			
測点	X n	Y n	距離
Y29	-219734.109	-74353.959	2.611
Y30	-219731.995	-74355.491	4.000
Y31	-219731.712	-74359.481	2.611
Y32	-219733.588	-74361.297	7.356
		地積	11.35 m <sup>2</sup>

地番 水路			
測点	X n	Y n	距離
Y16	-219754.833	-74409.903	4.016
K152	-219756.902	-74413.345	16.513
K181	-219771.207	-74405.095	9.227
K179	-219779.201	-74400.487	1.158
X22	-219780.355	-74400.589	1.478
K178	-219781.827	-74400.718	0.199
K191	-219782.009	-74400.638	0.180
X14	-219782.168	-74400.554	0.979
PK23	-219781.643	-74399.728	0.938
CK24	-219782.103	-74398.911	10.718
HDC38	-219791.792	-74394.329	0.735
11	-219792.295	-74393.793	3.144
8	-219792.969	-74390.722	17.351
9	-219796.703	-74373.778	17.327
M18	-219800.470	-74356.865	1.446
Y6	-219799.058	-74356.553	20.961
Y5	-219794.509	-74377.014	14.950
Y4	-219791.264	-74391.608	9.691
Y3	-219782.868	-74396.447	15.082
Y2	-219769.801	-74403.978	14.051
Y1	-219757.627	-74410.995	3.000
		地積	131.97 m <sup>2</sup>

地番 開発道路			
測点	X n	Y n	距離
K152	-219756.902	-74413.345	4.016
Y16	-219754.833	-74409.903	9.138
Y15	-219750.072	-74402.103	5.000
Y14	-219750.624	-74397.134	4.907
Y13	-219754.036	-74393.608	8.481
Y12	-219761.384	-74389.373	15.081
Y11	-219774.450	-74381.842	8.182
Y10	-219781.539	-74377.757	3.540
Y9	-219782.307	-74374.301	17.424
Y8	-219786.088	-74357.292	5.000
Y7	-219790.307	-74354.609	8.964
Y6	-219799.058	-74356.553	1.446
M18	-219800.470	-74356.865	2.523
13	-219802.936	-74357.400	6.010
12	-219804.247	-74351.535	6.537
M16	-219797.862	-74350.134	9.940
Y17	-219788.160	-74347.973	5.573
Y18	-219782.696	-74349.068	4.242
Y78	-219778.555	-74348.146	0.401
Y19	-219778.468	-74348.537	13.464
Y20	-219765.326	-74345.610	15.449
Y21	-219750.246	-74342.252	4.000
Y22	-219747.836	-74339.060	9.262
M8	-219748.373	-74329.814	5.000
Y74	-219743.378	-74329.591	9.195
Y73	-219742.844	-74338.770	4.000
Y72	-219741.399	-74342.500	8.860
Y71	-219734.225	-74347.699	4.000
Y70	-219730.275	-74347.069	13.562
Y92	-219722.424	-74336.011	5.999
Y91	-219717.532	-74339.484	13.610
Y63	-219725.411	-74350.582	5.501
Y62	-219725.962	-74356.055	7.696
Y94	-219719.933	-74360.839	5.500
Y90	-219714.488	-74360.064	14.876
Y89	-219705.876	-74347.934	17.804
Y88	-219695.569	-74333.417	12.499
Y87	-219688.333	-74323.225	6.207
Y82	-219684.363	-74327.996	13.615
Y81	-219692.245	-74339.098	12.623
Y80	-219699.552	-74349.391	12.671
Y79	-219706.887	-74359.723	13.978
PK46	-219714.979	-74371.120	0.600
Y56	-219715.468	-74370.773	10.869
Y46	-219723.978	-74364.012	4.000
Y45	-219727.973	-74364.213	15.048
Y44	-219738.787	-74374.677	11.508
Y43	-219747.057	-74382.680	7.500
Y42	-219749.352	-74389.820	12.364
PK10	-219740.754	-74398.705	0.900
Y41	-219741.401	-74399.331	18.877
X15	-219751.199	-74415.466	0.986
K12	-219751.689	-74416.322	6.003
Y38	-219779.481	-74359.367	14.864
Y37	-219776.255	-74373.877	7.772
Y36	-219769.521	-74377.758	10.558
Y35	-219760.374	-74383.030	5.000
Y34	-219755.412	-74382.416	13.500
Y33	-219745.711	-74373.028	16.870
Y32	-219733.588	-74361.297	2.611
Y31	-219731.712	-74359.481	4.000
Y30	-219731.995	-74355.491	2.611
Y29	-219734.109	-74353.959	9.738
Y28	-219741.994	-74348.244	4.000
Y27	-219745.911	-74347.433	5.359
Y26	-219751.142	-74348.598	16.501
Y25	-219767.248	-74352.185	9.476
Y24	-219776.497	-74354.245	5.928
		地積	1792.96 m <sup>2</sup>

変更後

図面の名称		図面番号
区画割図求積表		
設計		